

# SALVATEC

Experts in collective swimmingpools

## Hydraulic Pool lift

Fixed adjustable hydraulic lift for pool, with low maintenance, with high safety features and adaptable to all pool surfaces.

AB40LB111 / AB4XLB111

## TEC - B4

TEC - B4 <sup>XL</sup>

- **Equipment recommended for seasonal pools.**
- **Fixed pool lift with an anchor attached to the swimming pool.**
- **Adaptable to all types of pools**, including non-overflowing ones. Its adjustable structure allows it to be adapted to different types of pool profiles.
- **Adjustable according to the depth of the pool.** Suitable for shallower pools.
- **Easy installation**, it only requires three stainless steel plugs, bolted to the pavement and three simple supports.
- **User friendly access.** Water-facing transfer with rigid footrest for greater comfort and safety of the user.
- **Maximum autonomy** for people with reduced mobility. Double operation system activated from the inside and the outside of the swimming pool to offer greater independence to the user.
- **Manufactured at Blautech** the structure is constructed in stainless steel AISI 316L and the seat is made of polypropylene, materials suitable for outdoor use.

### ASSEMBLY INSTRUCTIONS

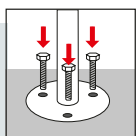

Present the pool lift, mark and drill the 3 holes.

Ø12-12,5mm

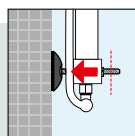

Position the hoist and the earthing terminal.

Adjust the lower stop.

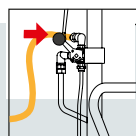

Fit the water connection to supply the circuit.

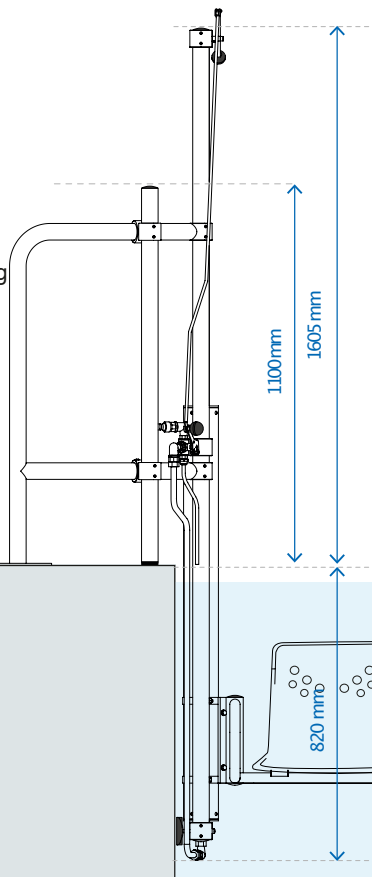

### TECHNICAL DATA

Maximum lifting capacity: 120 kg

Turning angle: 160°

Required pressure: 3,5a 5bares

Anchor arm: 355mm / XL 655mm

Minimum depth: 800 mm

Weight: 43 kg / XL 44,5Kg

Dimensions: 2425x 700mm

### EC DECLARATION OF CONFORMITY



We declare under our responsibility that the machine:  
Type: Hydraulic pool lift for people with reduced mobility  
Make: TEC - B4  
Conforms to the essential Health and Safety requirements of the Directives: 98/37CE "Máquinas"  
And is in conformity with harmonised European standards:  
UNEENISO12100-1    UNEENISO12100-2  
UNEEN982    UNEEN418  
UNEEN1050    UNEENISO10535

